



# POWEREX

Reliable Energy Protection

## PLUS SERIES

### 6KVA / 10 KVA

2Phase: 2Phase

FP : 1

#### APPLICATIONS

IDC (Internet Dater Center) - Network - Servers  
and workstations - Control System -  
Communication System - Office - Pc, etc.



## FEATURES

- ▶ True online double - conversion technology
- ▶ Wide input voltage range
- ▶ DPS and Three level technology
- ▶ Advanced PFC technology, input PF > 99%
- ▶ Cold start
- ▶ Automatic battery charging on/off mode
- ▶ Lightning and surge protection
- ▶ LCD/LED display
- ▶ Support generator connection
- ▶ Smart slot for mission critical applications

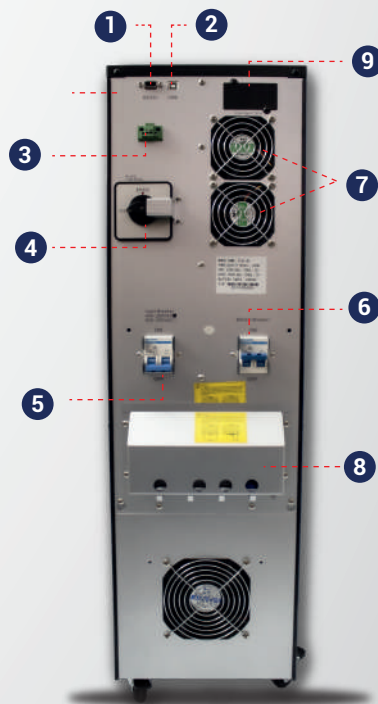

- 1 RS232 PORT
- 2 USB PORT
- 3 EPO
- 4 Maintenance bypass
- 5 Input Breaker
- 6 Battery Breaker
- 7 Fan
- 8 Input / Output / Ext Battery
- 9 SNMP Intelligent (Optional)

## TECHNICAL SPECIFICATIONS

Model	PLUS 6K	PLUS 10K
Capacity	6Kva / 6Kw	10Kva / 10Kw
<b>Input</b>		
Nominal Voltage	208/220/230/240Vac,L1+L2+PE	
Voltage Range	110-300VAC	
Frequency Range	50/60±6Hz,±10Hz(Settable), 40-70Hz	
Power factor	≥ 0.99	
Distorsion	≤5%THD(Linear Load); ≤8%THD(Non-linear Load)	
<b>Output</b>		
Nominal Voltage	208/220/230/240Vac or 104/110/115/120Vac, isolated transformer output	
Power factor	1	
Voltage Regulation	±1%	
Frequency	Online mode: according to AC frequency, battery mode: 50/60Hz±0.1%	
Harmonic Distorsion	≤2% THD (Lineal Load); ≤5%THD (Non-linear Load)	
Transfer time	0ms, ECO Mode to battery Mode 2ms	
Load Capacity	AC Mode: 30min @ 102%~110% Load 10min @ 110% ~ 130% Load 30s @ 130% ~ 150% Load 500ms @ > 150% Load	Battery Mode: 10min @ 102%~110% Load 1min @ 110% ~ 130% Load 10s @ 130% ~ 150% Load 500ms @ > 150% Load
<b>Battery</b>		
Voltage	192Vdc/216Vdc/ 240Vdc	
Battery Number	12Vdc 7AH*20pcs	12Vdc 9AH*20pcs
Charge Current	1-12A settable	
Typical recharging time	6~8 hours (to 90% of full capacity)	
Typical backup time	7 - 8 minutes full load / 23 minutes half load	
<b>Efficiency</b>		
AC Mode	Full load efficiency 95%	
Battery Mode	Full load efficiency 94.8%	
<b>Communication</b>		
Interface	EPO, RS232 / SNMP card (optional) / USB Port	
<b>Enviroment</b>		
Operation Temperature	0~40°C	
Working ambient humidity	20%~95% (non-condensing)	
Altitude	<1000m, Derating at above 1000m, maximum 4000m, Refer to IEC62040	
Noise Level	<50dB	
<b>Physical</b>		
Dimension (W*D*H) mm	250*500*860	
Weight (Kg)	104.6	121.3
<b>Standards</b>		
Safety	IEC/EN62040-1,IEC/EN60950-1	
EMC	IEC/EN62040-2,IEC61000-4-2,IEC61000-4-3,IEC61000-4-4,IEC61000-4-5,IEC61000-4-6,IEC61000-4-8	